

# Franklyn James



## Ionian Building

45 Narrow Street, London, E14 8DW

£2,000 Per Calendar Month

Positioned on the third floor is this bright and spacious one-bedroom apartment located in a popular modern development in Limehouse. The apartment features a sizeable open plan reception room with a fully integrated kitchen and a private balcony, one double bedroom, and a modern three-piece bathroom. This property also benefits from fibre broadband connection and 24-hour concierge.

The Ionian Building forms part of Narrow Street's 'Mosaic' development and is one of the most sought-after locations in all E14. Historic Narrow Street and the development itself have a wide range of local shops, eateries and restaurants and there is also a high level of amenities on bustling Commercial Road. Residents also enjoy riverside walks, running and cycling along the Thames Path. There is superb connectivity to key London locations such as financial hubs of Canary Wharf and the City of London, with DLR and National Rail services just moments away.

- Great location
- Third floor
- One double bedroom
- Private balcony
- 24 hour concierge
- Modern three piece bathroom
- Local amenities
- Abundance of natural light
- Excellent transport links
- Short commute to Canary Wharf

### Viewing

Please contact our Limehouse Lettings Office on 02077911777 if you wish to arrange a viewing appointment for this property or require further information.



1



1



1



C

# Floor Plan

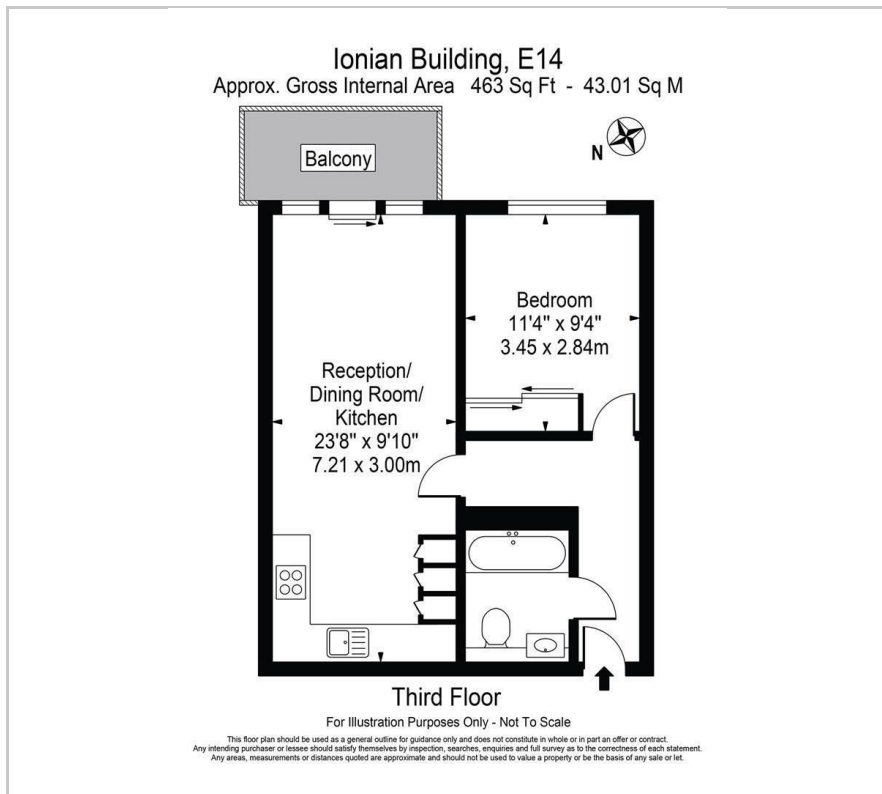

# Area Map

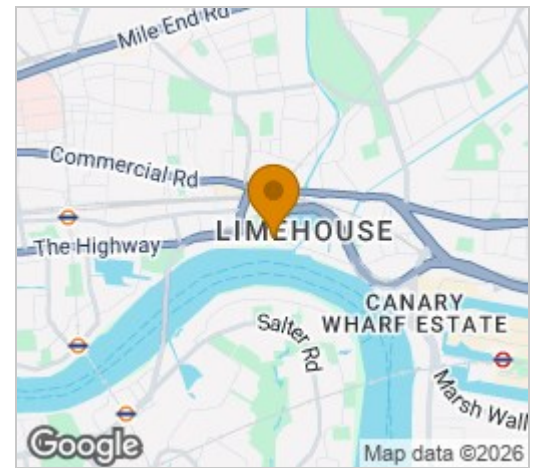

# Energy Efficiency Graph

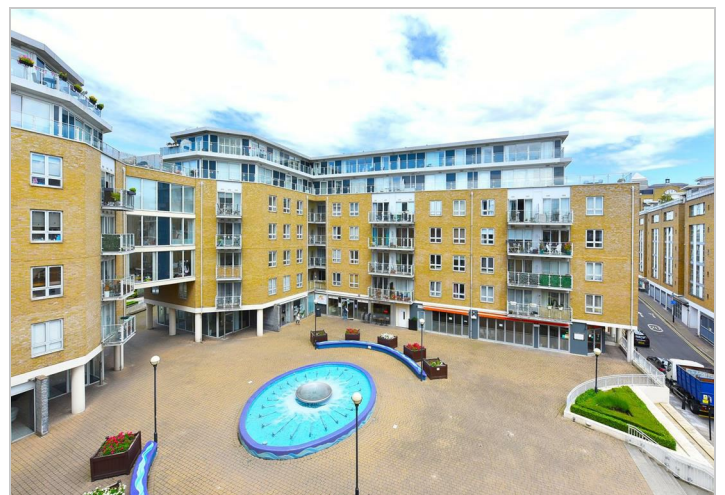
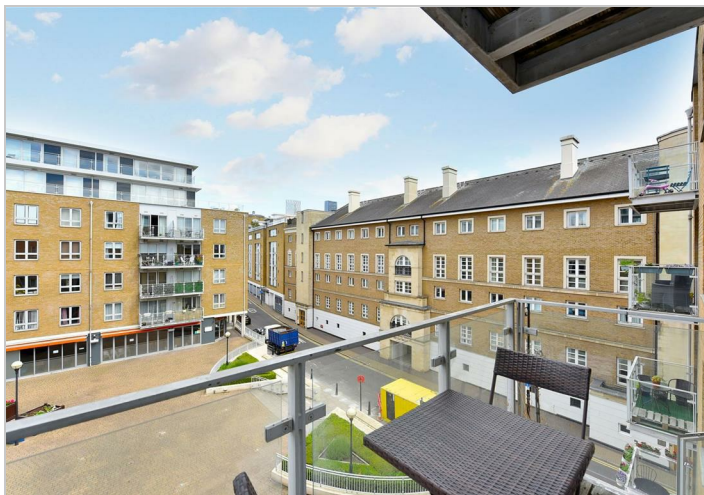
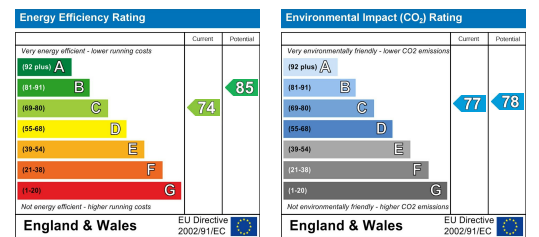

These particulars, whilst believed to be accurate are set out as a general outline only for guidance and do not constitute any part of an offer or contract. Intending purchasers should not rely on them as statements of representation of fact, but must satisfy themselves by inspection or otherwise as to their accuracy. No person in this firm's employment has the authority to make or give any representation or warranty in respect of the property.